

# EMERGENCY STORM SHELTER

**Weds. January 4 to Fri. January 6, 2023**

**\*Opening at 12 p.m. on 1/4/2023**



## LOCATION

Washington High School - Small Gymnasium  
38442 Fremont Blvd, Fremont, CA 94536

\*Enter from the parking lot on Country Dr.

## SERVICE ANIMALS & PETS ACCEPTED

All animals except ADA service animals will be kenneled on site with food and water



## FOOD & SUPPLIES

Warm meals, beverages, and face masks will be provided. Winter supplies will be available while supplies last.

## CONTACT US FOR MORE INFO



510-574-2050



[Check City webpage for updates](#)



[humanservicesinfo@fremont.gov](mailto:humanservicesinfo@fremont.gov)

# Storm Shelter Location

Washington High School - Small Gymnasium  
 38442 Fremont Blvd, Fremont, CA 94536

**\*Enter from the parking lot on Country Dr.\***

Supply

Unloading/Staging

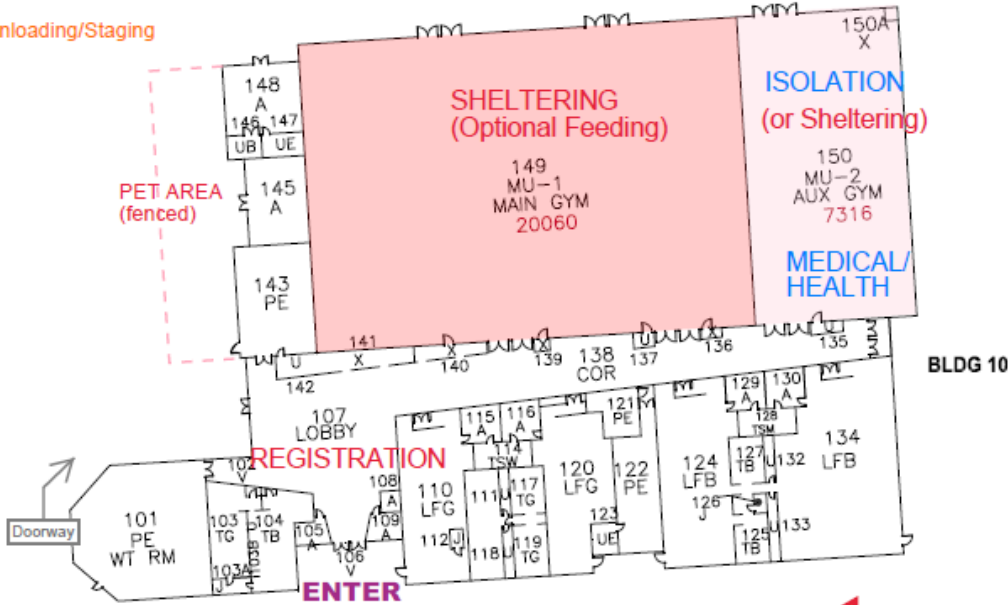

(E) TOILET

**ENTER FROM  
 PARKING LOT  
 AT THE  
 CORNER OF  
 FREMONT  
 BLVD &  
 COUNTRY  
 DR.**

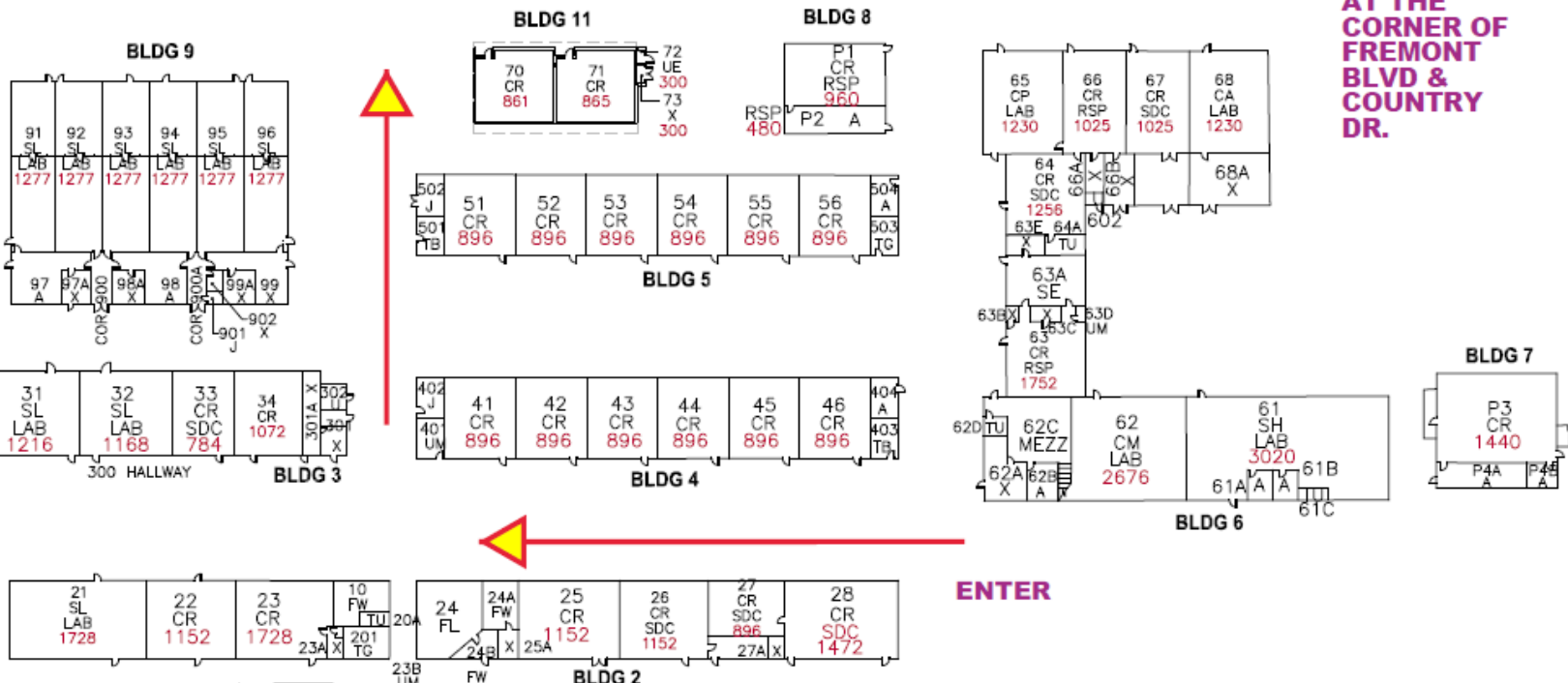

**ENTER**